



EAST CHINA PERFORMING ARTS CENTER

Lighting

-Lighting control PC with Horizon software and a 24 sub master wing. 2 Universes of DMX distributed via PathPort nodes. Our standard rep plot features 2 full stage back light washes of 20 PAR 64 WFL's, a full stage 10 instrument front of house wash with Source IV lekos, 3 color top and bottom cyc washes, 10 specials per overhead electric (5 26 degree and 5 36 degree), and 5 19 degree front of house specials with I-Cues and DMX Iris units.

- 200 - 2.4K Entertainment Technology IPS dimmers (dimmer per circuit –fixed location)
- 24 ETC Source IV 19 degree ellipsoidal reflector spotlight with HPL 575 lamps
- 16 ETC Source IV 26 degree ellipsoidal reflector spotlight with HPL 575 lamps
- 29 ETC Source IV 36 degree ellipsoidal reflector spotlight with HPL 575 lamps
- 9 ETC Source IV 50 degree ellipsoidal reflector spotlight with HPL 575 lamps
- 30 ETC Source IV 10 degree lens tubes
- 40 Par 64 with WFL lamps (limited number of MFL, NSP, and VNSP lamps available)
- 5 Par 16 (Birdies) with WFL lamps
- 8 L&E mini strip lights (3 color)
- 7 Selecon HUI 3 cell cyc lights (configured for ground row)
- 2 Apollo Smart Move DMX dual gobo rotators
- 5 Rosco I-Cue units hung from the FOH catwalk, with Apollo EZ DMX Iris units
- 1 Martin Fogger
- 1 Martin Hazer
- 2 Lycian HP 1209 follow spotlights with MSR 575 HR lamps
- 1 Epson 7800 Video Projector with long-throw lens (with DVD player and VCR)
- 400A 3 phase 5 wire Company Switch is available up stage right (cam-lok or lug tie in)
- Vast assortment of stage pin cable, twofers, and edison cables
- 1 – 50' six circuit run of stage pin multi cable with fan ins and outs
- 1- 25' six circuit run of stage pin multi cable with fan ins and outs
- 1 – 100' six circuit run of multi cable
- 2 – 75' six circuit run of multicable
- 1 set of Edison fan-in and fan-outs
- 4 – 50lb. boom bases with 8' tall 1.5" schedule 40 pipes

** All instruments and circuits have standard 2 pin and ground stage pin connectors.*

SOUND

Previous experience has proven that little sound reinforcement is needed. It is a major concern of management that sound pressure levels remain within an acceptable range.

- House mixer is an Allen and Heath QU-32 32 channel mixer located in an “open air” mix area in center of house
- Main PA system consists of a *mono* line array hung at the cent of the proscenium made up of 5 Renkus-Heniz CFX-101-LA8 speakers, 2 Renkus-Heniz CFX15S subwoofers, and 2 JBL AM5212/64 for front / out fills.
- 2 Renkus Heinz monitor speakers with 12” woofers
- 4 EV ELX 112 monitor speakers
- 2 Galaxy Audio Hot SpotVC monitor speakers
- 4 channel QSC amp to power monitor speakers
- Dedicated sound computer with Echo AudioFire8 8 channel sound card and Show Cue System and Audacity software.
- 1 Marantz CD Player
- 6 Shure SM 58 dynamic cardioid microphones
- 6 Shure SM 57 dynamic cardioid microphones
- 3 Shure KSM 137 cardioid condenser microphones
- 3 Sennheiser e604 cardioid dynamic microphones
- 1 Shure Beta 52 large diaphragm cardioid dynamic microphone
- 1 Shure MX 412 cardioid condenser microphone
- 3 Bartlett TM 125C boundary microphones
- 3 Audio Technica Pro 45 hanging microphones
- 6 Whirlwind IMP2 passive direct boxes
- 3 Klark Technic DN100 active direct boxes
- 14 Shure SLX wireless lavalier microphones with Countryman B3 mic elements
- 4 Shure SLX wireless handheld microphones with SM 58 mic capsules (2 Beta 87A mic elements also available) * *Note that only 14 total wireless mics can be used at one time.*
- 1 Ashley NE4800 Digital Signal Processor (for mains – fixed and not adjustable)
- House PA tie ins are available at the discretion of the PAC Manager
- 2 channels of Clear-Com intercom are located in all key production positions (house has 6 belt packs, 6 headsets, and 4 channel main station with headset)
- Assorted stands, mounts, cables, and adaptors are available
- There is a Lobby / Backstage paging and chime system installed in the facility
- Telex listening assisted devices are available for those who are hard of hearing (state id or driver license requires as a “deposit”)
- There is a closed circuit video system that broadcasts a program feed to the Lobby, Black Box, Fly Rail, and Stage Managers Station (down stage right) and Down Left. Our 2 Dressing Rooms, Scene Shop, Control Rooms, and Costume Room all have audio program feed with independent volume control.
- The facility also has a 9’ Steinway Series D grand piano, a set of 4 Yamaha concert timpani, and a full stage Orchestra Shell available for rental.

Rigging

All line sets are single purchase counterweight sets operated from stage right. All legs and borders are made of black velour without fullness. Empty battens have a capacity of 1,950 lbs.; Electrics have a 3,000 lb working capacity (capacity assumes even distribution along the batten/ lift lines). Battens adjacent to electrics do not have enough clearance to be used to fly backdrops or scenery. Just because a line set appears to be empty and available does not mean there is enough clearance to use it to fly drops or scenic units. Many battens adjacent to electrics do not have enough clearance to be used for this purpose. All rigging must be approved by the PAC Manager *in advance*.

Line Set Schedule

<u>Set #</u>	<u>Distance from PL</u>	<u>Description</u>	<u>Notes</u>
-	1'-7"	Main Border (dead hung)	Permanent
1	2'-4"	Main Curtain (guillotines and travels)	Permanent
2	3'-1"	N/A	
3	4'-1"	First Electric	Permanent
4	4'-10"		
5	5'-7"		
6	6'-4"	Shell Ceiling # 1	Permanent
7	-	Stage Right Side Tab	
8	7'-7"		
9	8'-6"	Projection Screen (10'-6" x 14'-0")	
10	9'-3"	Border	
11	10'-0"	Legs	
12	10'-9"	Second Electric	Permanent
13	13'-0"	Mid-Stage Black (guillotines and travels)	Permanent
14	13'-9"		
15	14'-6"	Shell Ceiling # 2	Permanent
16	-	Stage Left Side Tab	
17	16'-0"	Border	
18	16'-9"	Legs	
19	17'-6"		
20	18'-3"	Third Electric	Permanent
21	19'-0"		
22	19'-9"		
23	20'-6"		
24	21'-3"		
25	22'-0"	Shell Ceiling # 3	Permanent
26	23'-10"	Border	
27	24'-7"	Legs	
28	25'-4"	Fourth Electric	Permanent
29	26'-1"		
30	27'-0"		
31	27'-9"		
32	28'-6"	Border	
33	29'-3"	Legs	
34	30'-0"	Full Black	
35	30'-9"	Fifth Electric	Permanent
36	31'-6"		
37	32'-3"	Cyclorama	

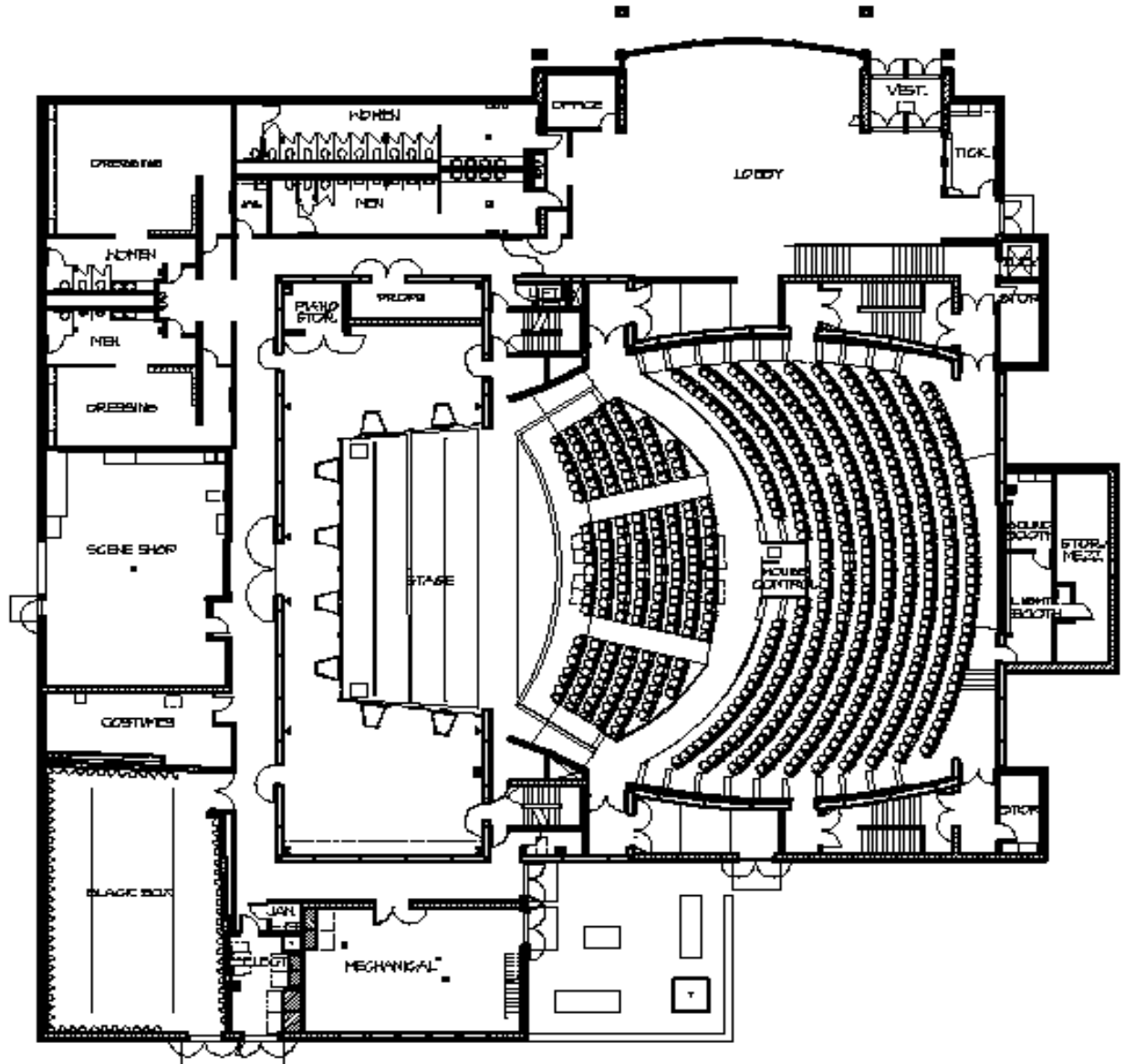

ADDRESS: 1585 Meisner East China, MI 48054
 PAC Manager: David Simpson (810) 676-1146 Dsimpson@ECSD.us

BLANK PAGE